



European flagship Action for cold ironING in ports



Co-financed by the Connecting Europe  
Facility of the European Union

# Port Authority of Huelva



1

EALING PROJECT

2

OPS IN THE PORT OF HUELVA

# 1 EALING Project

# 42

## Months

EALING Action number 2019-EU-TM-0234-S is a 36 months long Connecting Europe Facility project aiming at proposing a common EU harmonised and interoperable framework for the transition to electrification for at least 16 EU maritime ports in different sea basins.

# 16

## Ports

16 EU Ports belonging to different sea basins - Mediterranean, Black Sea and Atlantic Sea – are the pilot sites for the studies defining the technical, legal and regulatory framework to accelerate the implementation of OPS solutions.

# 22

## Partners

Representing the maritime community with Port Authorities, consulting companies in power system, energy and engineering, logistics, research and development bodies, IT suppliers.

# 1

## Global project

EALING Studies are the first phase of the Global project “European flagship action for cold ironing in ports” (EALING) that aims at accelerating the effective deployment of OPS solutions in the EU maritime ports, including the Action “EALING Works Valenciaport” and a further phase to implement at least 30 installations in at least 16 EU ports of the Consortium.

## Partners and location

### 22 Beneficiaries from 9 EU Member States:

- **13 Port Authorities** (Valencia, Barcelona, **Huelva**, Gijón, Venice&Chioggia, Trieste&Monfalcone, Ancona, Piraeus, Koper, Rafina, Constanta, Leixoes, Açores)
- **2 Port & Maritime Public Institutions** (Bulgarian Ports Infrastructure Company; Marine Institute)
- **7 Port & Shipping related entities** (Fundación Valenciaport, Circle, Ocean Finance, Symbios Funding & Consulting, Protasis, Hydrus Engineering, Fincantieri SI)

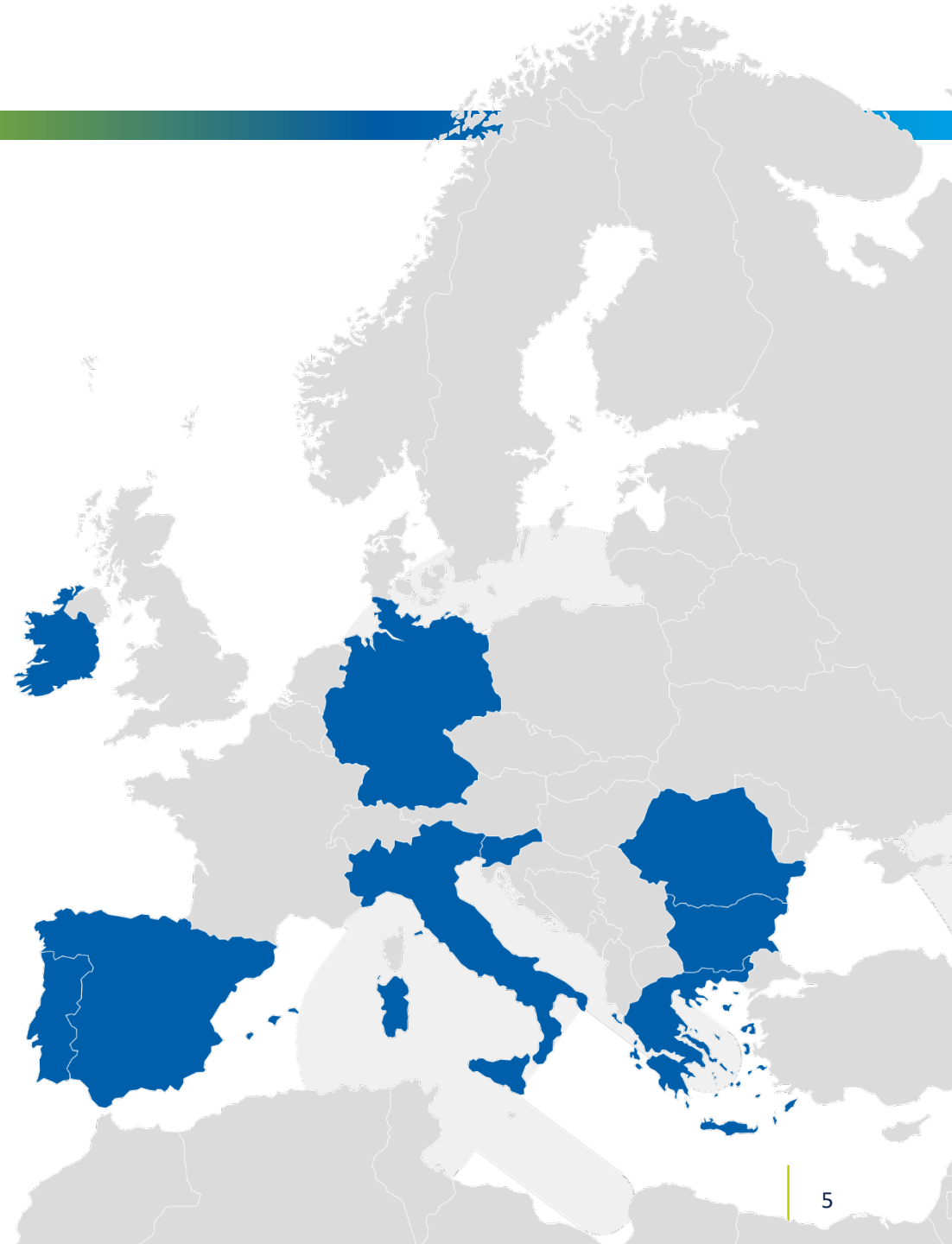
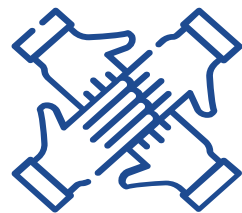



# EALING

- Port of Valencia (Spain)
- Port of Barcelona (Spain)
- Port of Huelva (Spain)**
- Port of Gijon (Spain)
- Port of Venice and Chioggia (Italy)
- Port of Ancona (Italy)
- Port of Trieste & Monfalcone (Italy)
- Port of Burgas (Bulgaria)
- Port of Constanta (Romania)
- Port of Piraeus (Greece)
- Port of Rafina (Greece)
- Port of Varna (Bulgaria)
- Port of Koper (Slovenia)
- Port of Leixoes (Portugal)
- Portos dos Açores (Portugal)
- Port of Dublin and / or Cork (Ireland)

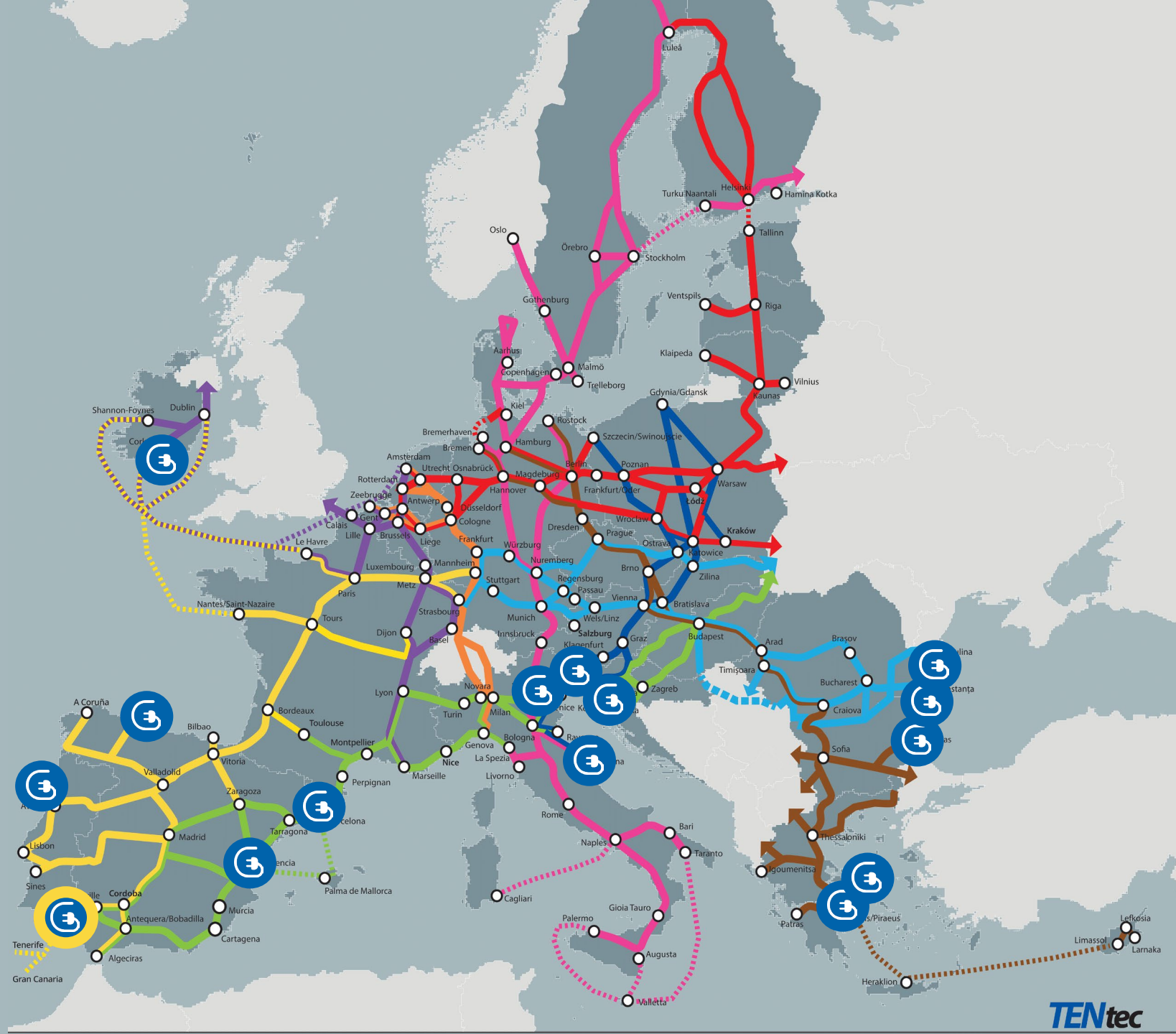

Co-financed by the Connecting Europe Facility of the European Union

# Partners



# OPS in the Port of Huelva



# Port of Huelva

## Atlantic Vision

Maritime positioning for trade relations between Europe, West Africa and America

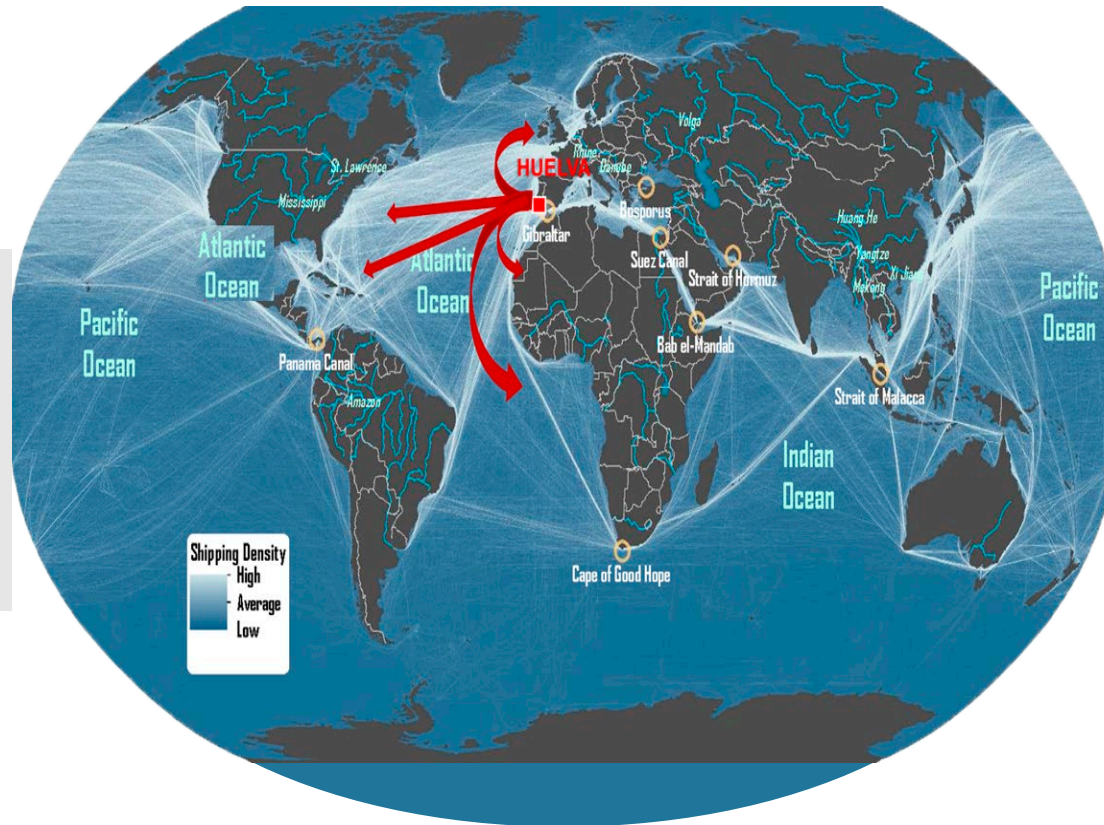

At the intersection of the major global Shipping and transshipment routes

Located in the South-West of Spain, 100 nm away from the Strait of Gibraltar

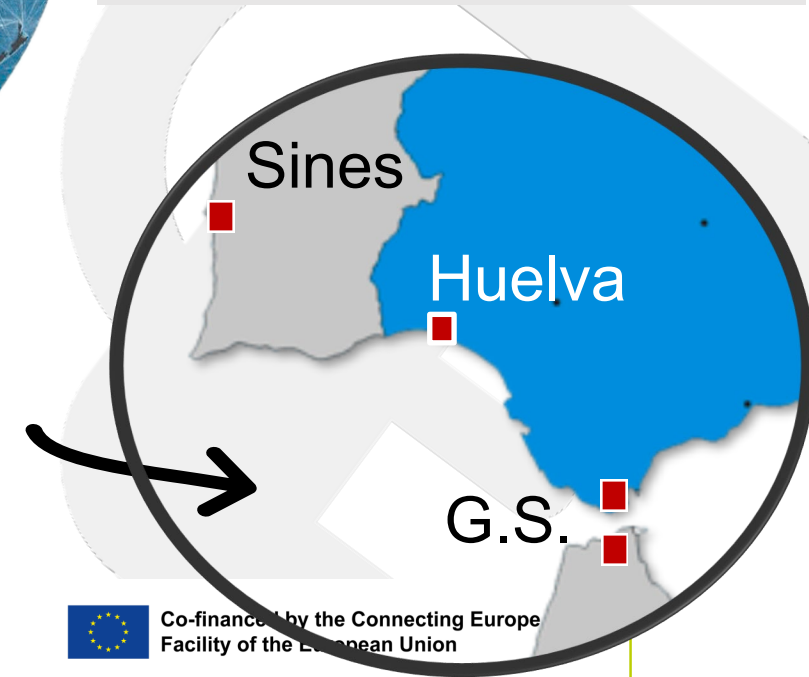



# Port of Huelva



# Port of Huelva

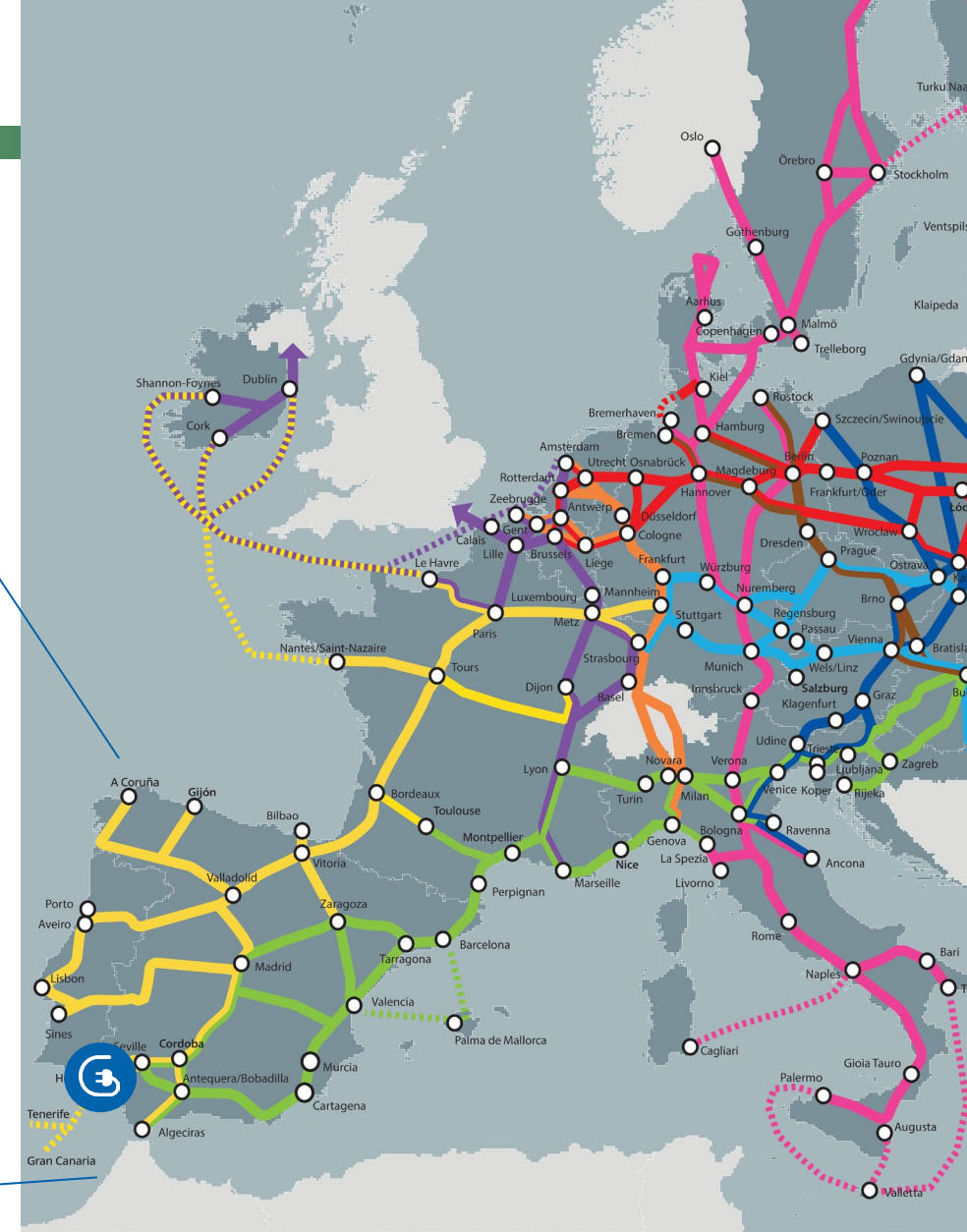

PORT OF HUELVA: OFFICIAL NODE OF THE **ATLANTIC CORRIDOR** TO THE CANARY ISLANDS



# Port of Huelva

1<sup>st</sup> Industrial Site of Andalusia, 2<sup>nd</sup> in Spain

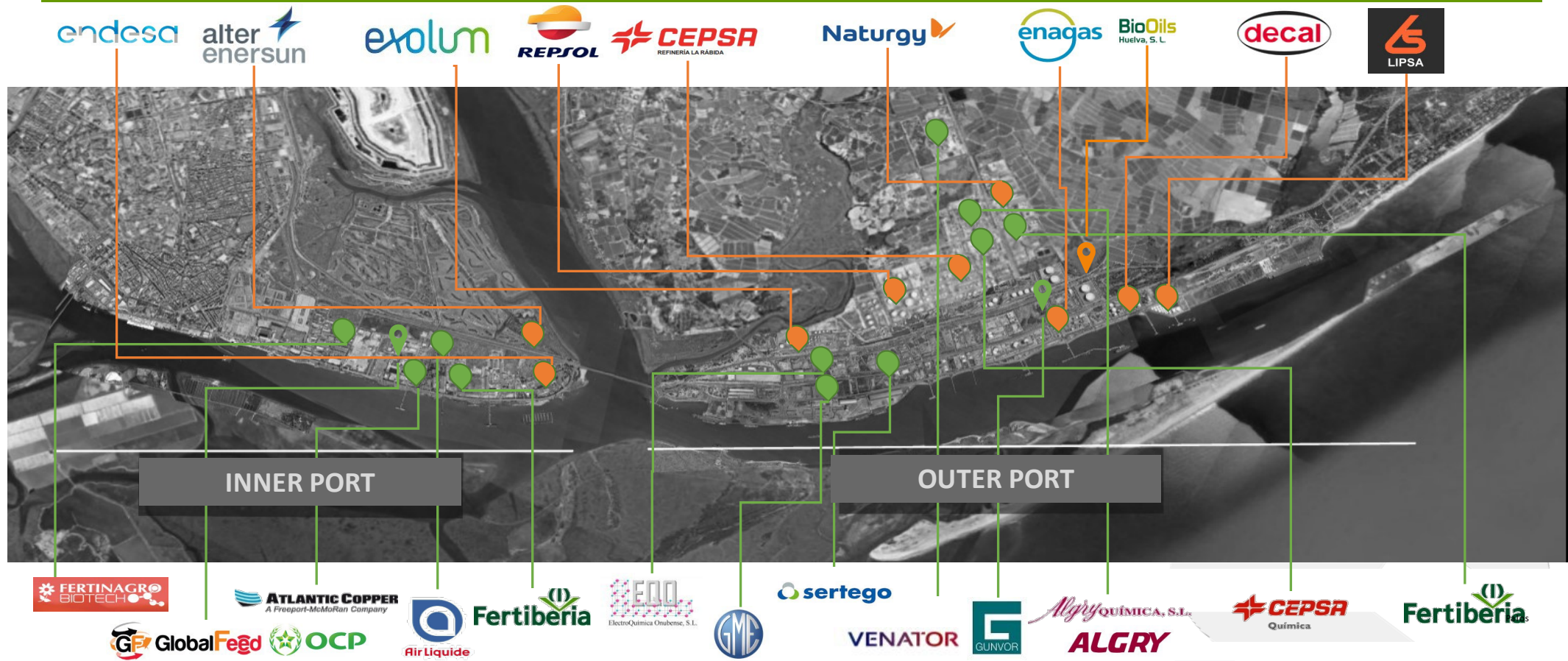

# Sustainability strategy of the Port of Huelva

Power supply and energy efficiency

OPS

Lighting

Building envelopes

Air conditioning

Awareness raising

Sustainable mobility

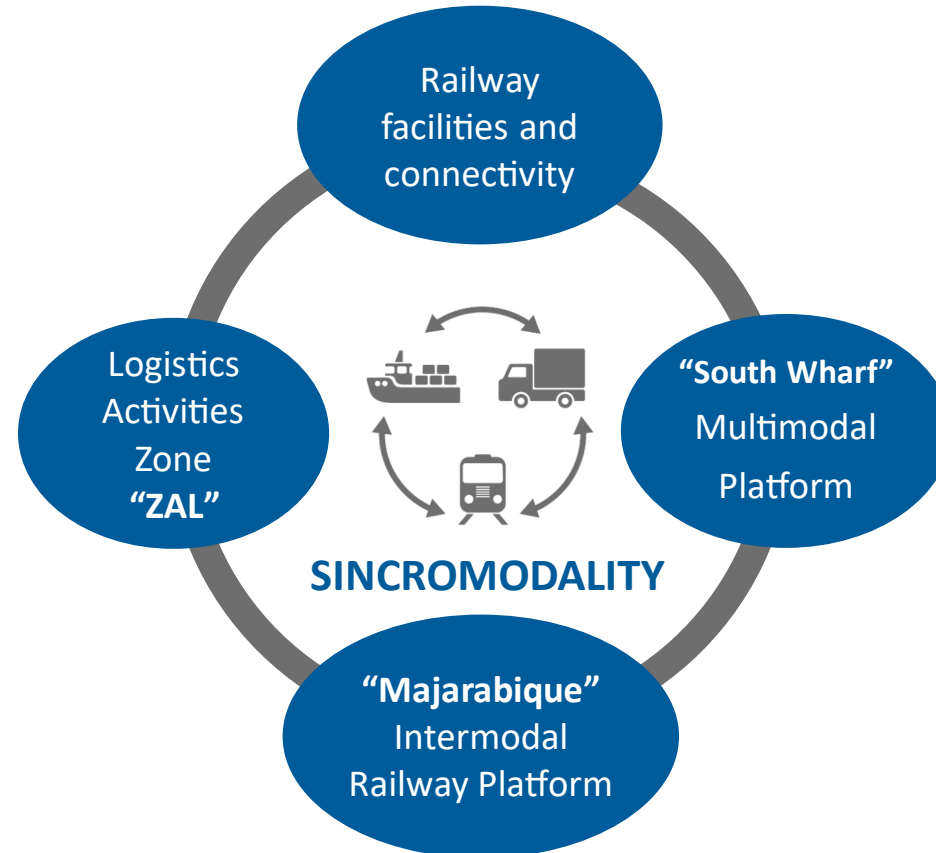

Alternative fuels

H2

Biogas

Ammonia

Methanol

Biofuels

LNG



# Sustainability strategy of the Port of Huelva

Power supply and energy efficiency

**OPS**

Lighting

Building envelopes

Air conditioning

Awareness raising

Sustainable mobility

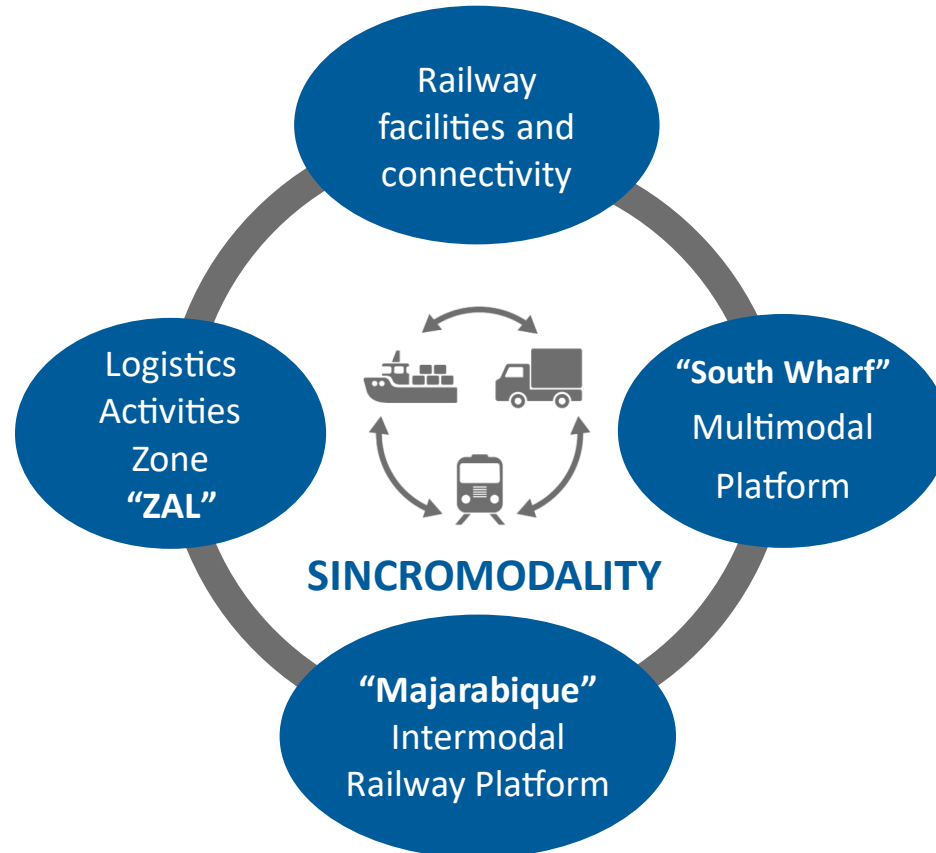

Alternative fuels

H2

Biogas

Ammonia

Methanol

Biofuels

LNG

# Port of Huelva



Huelva

ZAL

Logistics Activities Zone

Palos de la Fra.

Dry Bulk Terminals

Liquid Bulk Terminals

South Wharf:  
Containers, Ro-Pax and Multipurpose area

Fishing sector & shipyards

Port-City zone

Industrial Zone

La Rábida

Naturally sheltered port



ATLANTIC OCEAN

INNER PORT

OUTER PORT

1.700ha surface  
1.120ha sheltered waters  
18km length



# Port of Huelva





## Levante wharf

In the inner port is the Levante Wharf, a wharf very close to the city centre, with 320 m of mooring line, which is undergoing a major remodelling as part of the Port-City integration to become a powerful 80,000 m<sup>2</sup> commercial and leisure area with large, open, modern green spaces facing the sea, which will host, among others, nautical-sports, cultural and first-class restaurant activities.



# Levante wharf

- 630 kVA
- Multipurpose vessels
- 50 Hz
- Low voltage
- Possibility of simultaneous supply points

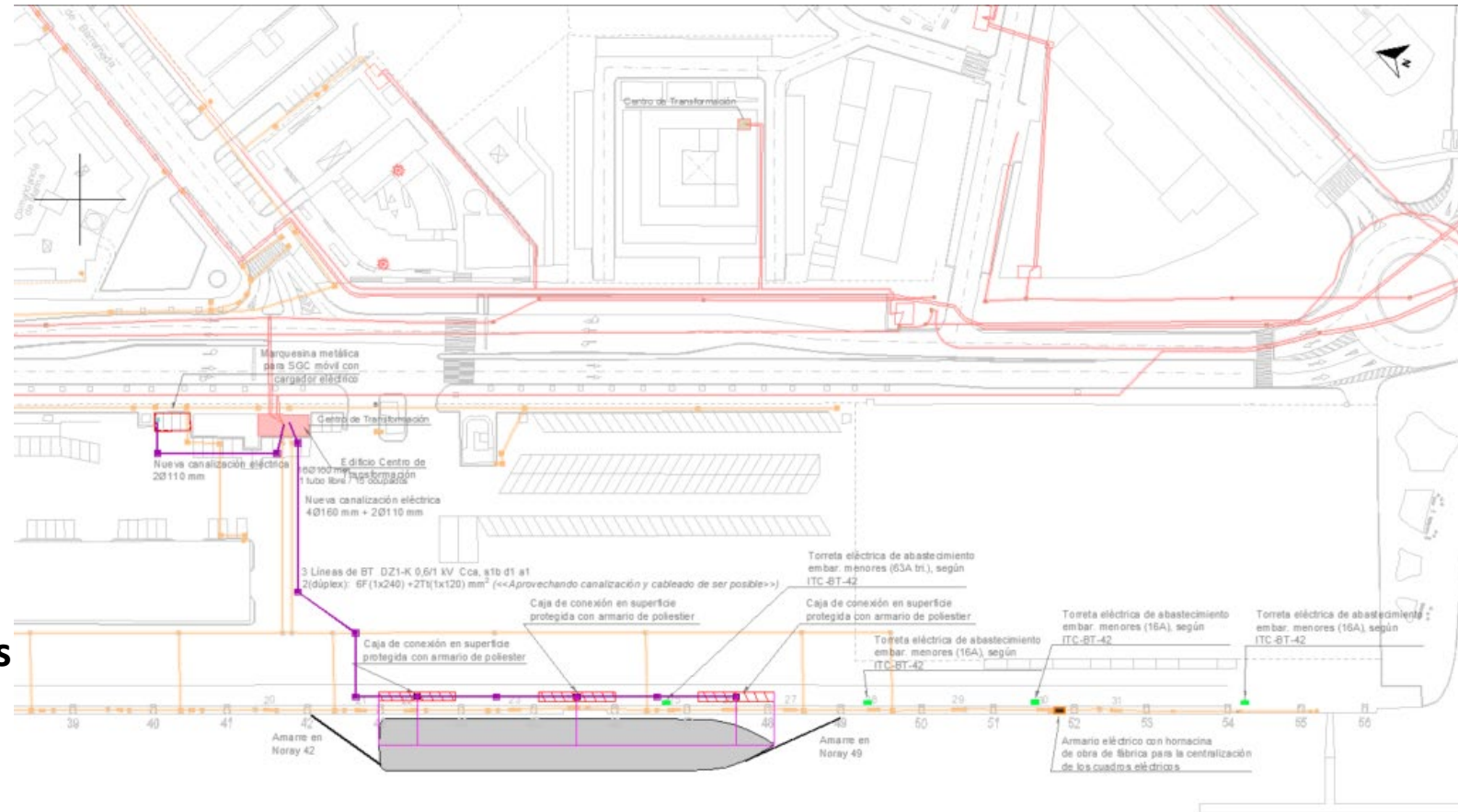



## Ro-Ro South Wharf

The Ro-Pax terminal is located on the South Wharf, where a second Ro-Ro ramp is currently being built, which will allow the simultaneous berthing of up to 4 vessels.

The terminal includes a passenger terminal and more than 50,000 m<sup>2</sup> of parking space. In addition, next to the Ro-Ro terminal is the rail-road terminal, where a rolling motorway project is being developed.



# Ro-Ro South Wharf

- 7 MVA
- Ro-Ro & Ro-Pax & Con-Ro vessels
- 50/60 Hz
- 11 kV
- 3 simultaneous supply points

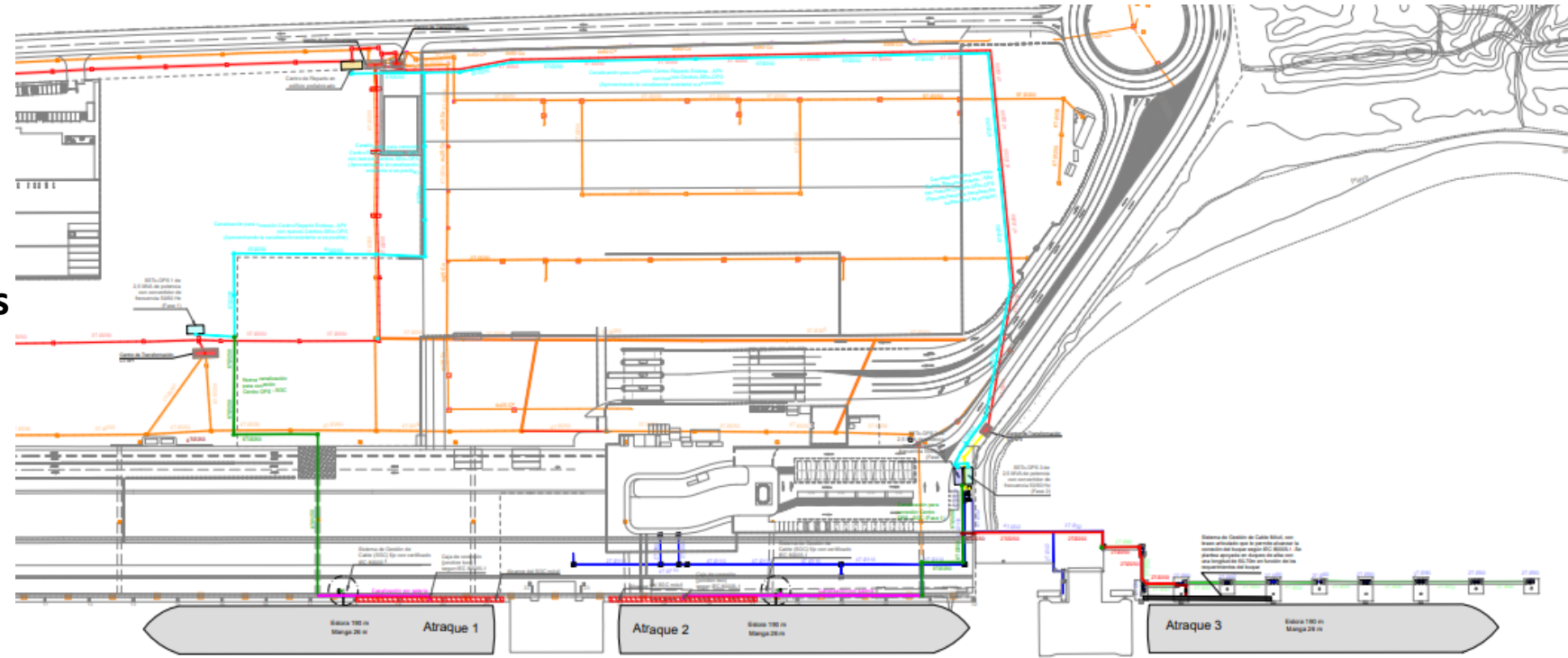

## Containers South Wharf

The container terminal is located on the South Wharf, and it has an annexed railroad terminal in its inner part, where containers from different regions of the Iberian Peninsula are received and dispatched, through the development of synchromodality.

It has a current surface area of 6 hectares and a capacity for expansion to almost 30 hectares.



# Container South wharf

- 18.75 MVA
- Container vessels
- 50/60 Hz
- 6.6 kV
- 2 simultaneous supply points

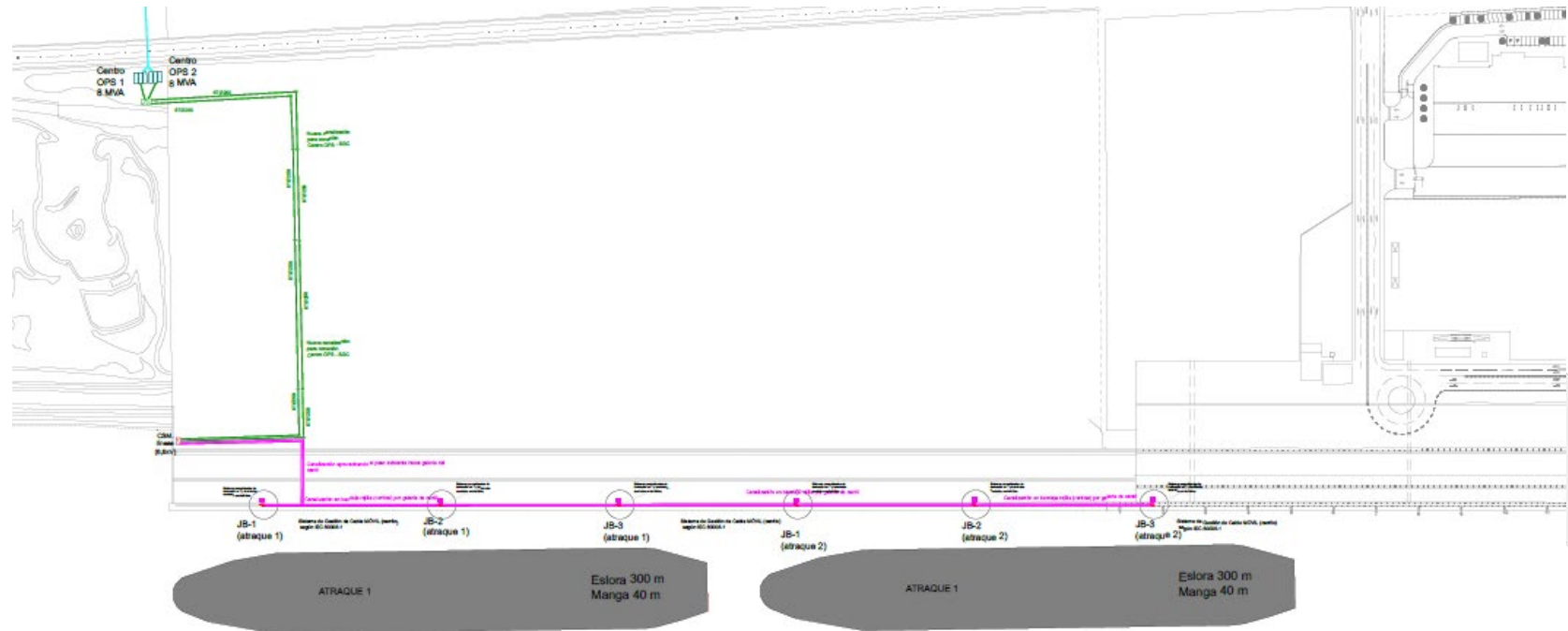



## Port of Huelva

Location	Total power	Vessel type	Characteristics
<b>Levante Wharf</b>	630 KVA	Multipurpose vessels	Low Voltage Shore Connection (400 V). 250 KVA available in case of a single connection. Possibility of simultaneous supply points with up to 0.6 MVA in total. 50 Hz available.
<b>Ro-Ro (South Wharf)</b>	7 MVA	Ro-Ro & Ro-Pax & Con-Ro vessels	High Voltage Shore Connection (11 kV). 3 OPS supply for Ro-Ro and Ro-Pax with a maximum power each of 2.5 MVA. 50 or 60 Hz available.
<b>Container (South Wharf)</b>	18.75 MVA	Container vessels	High Voltage Shore Connection (6,6 kV). 2 OPS supply for containers with a maximum power each of 7.5 MVA. 50 or 60 Hz available.



# Thanks!



European flagship Action for coLd ironING in ports

## Contacts

[manuelj.marquez@puertohuelva.com](mailto:manuelj.marquez@puertohuelva.com)

[comercial@puertohuelva.com](mailto:comercial@puertohuelva.com)

[cef.projects@puertohuelva.com](mailto:cef.projects@puertohuelva.com)

## Discover more at

[www.ealingproject.eu](http://www.ealingproject.eu)



**Co-financed by the Connecting Europe  
Facility of the European Union**

The document reflects only the author's view and the Agency is not responsible for any use that may be made of the information it contains.